



## KLEVER XCHANGE CARBON STEEL REPLACEMENT HEADS

Interchangeable, quick-change, snap-in heads for the Klever X-Change and X-Change PLUS line safety cutters. Keep the handle, replace the heads!



**KCJ-XH-20**

Locking tab

**KCJ-XH-20**  
Narrow (20) Head

Best for all around cutting applications.



**KCJ-XH-30**

Locking tab

**KCJ-XH-30**  
Wide (30) Head

Best for thicker substrates, plus all around cutting applications.



**KCJ-XH-40**

Locking tab

**KCJ-XH-40**  
Kurve (40) Head

Best for more abrasive substrates plus all around cutting applications.



**KCJ-XH-20TIN**

Locking tab

**KCJ-XH-20TIN**  
Titanium Coated Standard  
Narrow (20) Head

Titanium coated blade for increased durability.



**KCJ-XH-30TIN**

Locking tab

**KCJ-XH-30TIN**  
Titanium Coated Standard Wide (30)  
Head

Titanium coated blade for increased durability.

### Product/Packaging Specifications

Narrow Head (KCJ-XH-20) or Kurve Head (KCJ-XH-40)

500 pieces per case (bulk bag of 500)  
1 case = 10" x 7" x 5" = 4 lbs = 1.81 kg

Wide Head (KCJ-XH-30)

500 pieces per case (bulk bag of 500)  
1 case = 10" x 7" x 5" = 8 lbs = 3.63 kg

### Head Replacement Instructions

#### Removing the Head

Grasp head guard firmly. Grasp handle firmly while pressing thumb down on locking tab.

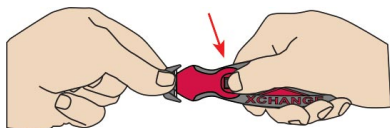

Pull the head from the handle.

#### Inserting the Head

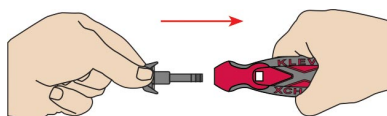

**Important:** Insert new head until locking tab clicks in place. Head should **NOT** pull back out without depressing the locking tab.

### Made in the USA

All Klever Innovations products are proudly made in the United States of America. Quality you can count on, attention to detail, and customer service that is second to none!

### Corporate Headquarters

Klever Innovations  
1734-C Airpark Dr.  
Grand Haven, MI 49417  
Phone: (800) 218-3068  
Fax: (616) 847-6824

### Patents

[Product Patents >](#)