

KLEVER *INNOVATIONS*

REDUCE CUT INJURIES • REDUCE DAMAGED GOODS • ALWAYS SAFETY READY



KLEVER STAINLESS SERIES



ANTIMICROBIAL KLEEN™ SAFETY CUTTERS

Combining Forces



Pacific Handy Cutter acquires
Klever Innovations.

With over 65 years of market leadership and ground breaking innovation, PHC has partnered with Klever Innovations, one of the brightest stars in the safety industry who pioneered protected blade technology. Together we are now the dominant leading force in safety cutting. Both companies offer protected blade and cutting solutions that reduce cut injuries and damaged merchandise—saving companies money! Now working together and continuing to offer “world class” customer service and product support, we are your complete cutting source for grocers, retailers, industrial facilities, food service providers and everyone in between.

It's about SAFETY

Our products are the
safest in the industry.



It's about SAVINGS

From fewer injuries
and damaged goods.

It's about INNOVATION

We design smarter to
work safer.



KLEVERINNOVATIONS We've taken our best to the next level

KLEVER KUTTER PLUS

- Kurved Blade for More Versatility, Easier, Cleaner Cuts
- Less Pull Force Reduces Hand/Arm Fatigue
- Improved Blade Life
- Disposable



KLEVER EXCEL PLUS

- Lighter Weight Handle
- Easier, Smoother Cuts
- Less Pull Force Reduces Hand/Arm Fatigue
- Disposable



KLEVER XCHANGE PLUS-HD

- Lighter Weight Magnesium Handle
- Increased Handle Life
- Highly Functional Tape Splitter
- Same Replaceable Head Options— Keep the Handle, Replace the Head



KLEVER KUTTER *The Original — Accept No Substitutes!*

It's the One that Started It All

The original Klever Cutter fits easily in a pocket and makes workplace injuries a thing of the past.

At Klever Innovations safety is job one. We work hard to develop tools that make the workplace safer and save companies money. Our products are dependable, easy to use, convenient, and stand up to the wear and tear of everyday use.

All Klever Innovations products are proudly made in the United States of America. Quality you can count on, attention to detail, and customer service that's second to none!



Available in red, orange, yellow, blue, and black. Complete product listing can be found at the end of the brochure.



Check out our new antimicrobial Kleen™ Kutter on page 15.

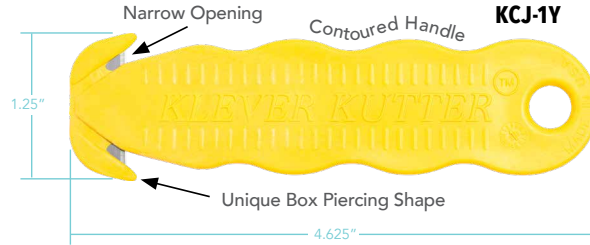

Safety and Convenience

- Recessed blade reduces cut injuries and damaged goods.
- Cuts boxes, film, tape, and thousands more applications.
- Small, convenient and durable with high-quality carbon steel blade.
- Advanced plastic polymers
- Highest safety level
- Disposable



KCJ-1RSS

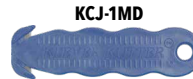

KCJ-1MD

Food Industry Solutions

Our food industry Cutters feature a stainless steel blade and are certified for non-splash zone. The KCJ-1MD is metal detectable. For more detailed information, please visit page 18.

KLEVER KUTTER PLUS



NARROW (KCJ-1)
Ideal for all around cutting applications.



KURVE (PLS-100)
More cutting surface produces smoother, easier cuts and reduces material bunching.



Klever Innovation's focus on safety is designed to reduce cut injuries and damaged goods.

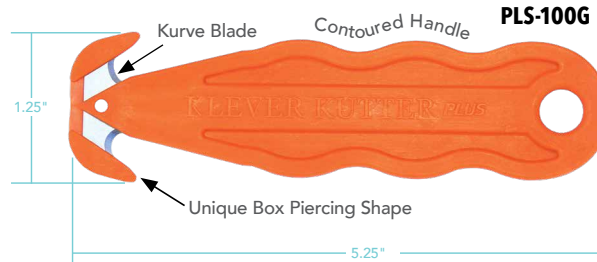

Safety and Convenience

- Recessed blade reduces cut injuries and damaged goods.
- Cuts boxes, film, tape, and thousands more applications.
- Durable, high-quality carbon steel Kurve blade for more versatility and easier, cleaner cuts.
- Less pull force reduces hand and arm fatigue.
- Advanced plastic polymers
- Highest safety level
- Disposable

Available in yellow, white and orange. Complete product listing can be found at the end of the brochure.



KLEVER XCHANGE *Keep the Handle, Replace the Head!*

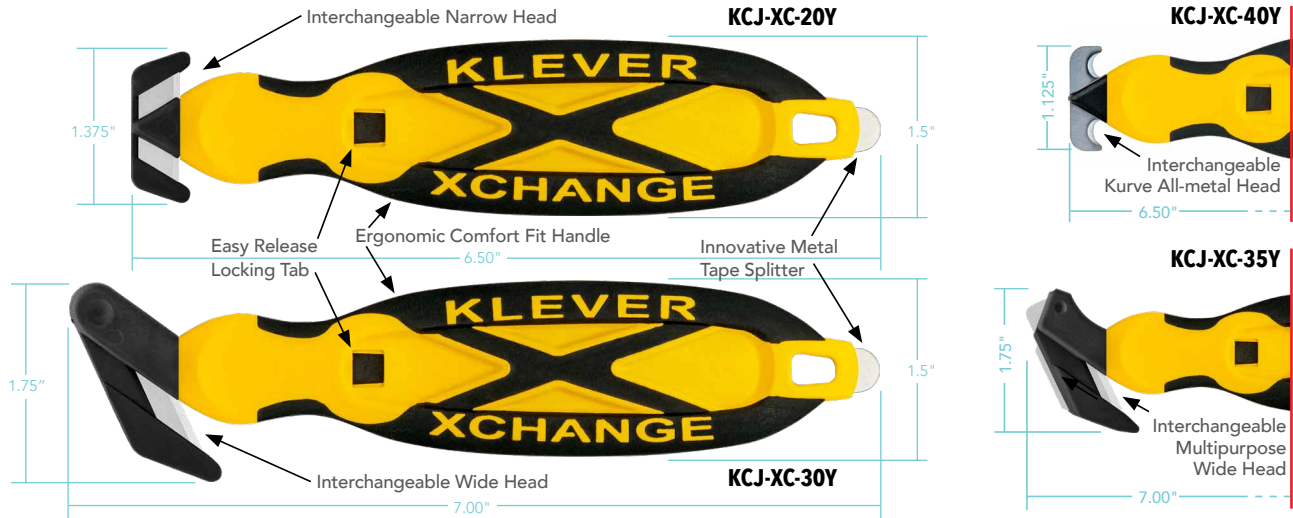

Safety and Convenience

- Recessed blade reduces cut injuries and damaged goods.
- Cuts boxes, film, tape, and thousands more applications.
- Ergonomic 'soft touch' handle reduces hand fatigue and stress.
- Innovative metal tape splitter
- Advanced plastic polymers — soft grip handle.
- Highest safety level
- Interchangeable, replaceable head.
 (1 pre-loaded head per handle. Additional sold separately.)



Handle available in yellow, orange, red, and blue. Complete product listing can be found at the end of the brochure.



REPLACEMENT HEADS SHOWN ON PAGE 8

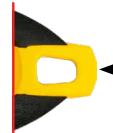

Plastic tape (PT) splitter option available in yellow handle ONLY
KCJ-XC-20Y-PT, KCJ-XC-30Y-PT, KCJ-XC-35Y-PT, KCJ-XC-40Y-PT



CHECK OUT THE NEW ANTIMICROBIAL KLEEN™ XCHANGE ON PAGE 16!

KLEVER XCHANGE PLUS

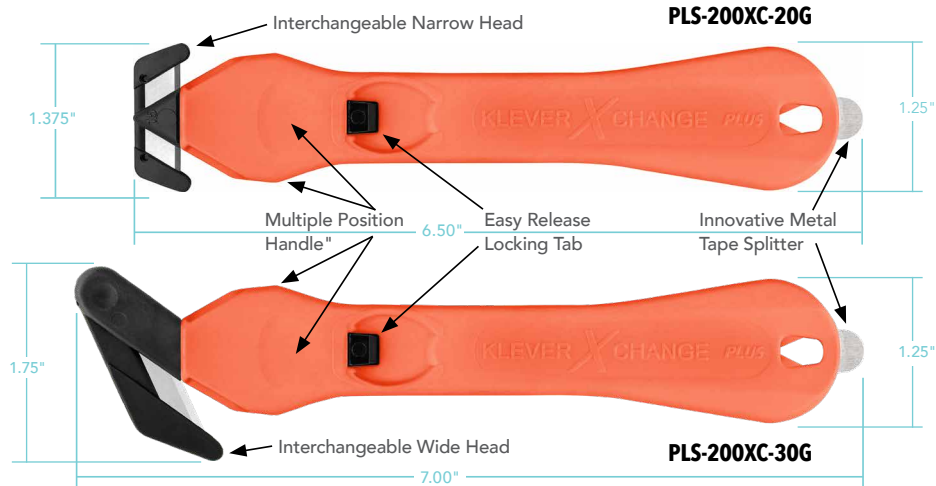
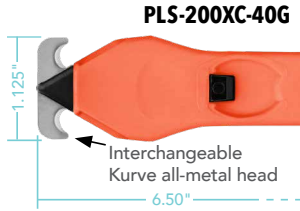

Precision cut guide reduces friction during the cut by directing the substrate to the blade.

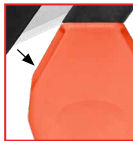

REPLACEMENT HEADS SHOWN ON PAGE 8

Safety and Convenience

- Recessed blade reduces cut injuries and damaged goods.
- Cuts boxes, film, tape, and thousands more applications.
- Lighter weight, multiple position handle; two positions for control and reach
- Innovative metal tape splitter
- Advanced plastic polymers
- Highest safety level
- Interchangeable, replaceable head (1 pre-loaded head per handle. Additional sold separately.)



KLEVER XCHANGE REPLACEMENT HEADS & ACCESSORIES

Quick-change, snap-in, interchangeable heads for the Klever XChange safety cutters.
Keep the handle, replace the head!



KCJ-XH-20

Locking Tab

KCJ-XH-20 Narrow Head
 Ideal for all-around cutting applications
KCJ-XH-20TN (Titanium)
 Titanium coated blade for increased durability



KCJ-XH-30

Locking Tab

KCJ-XH-30 Wide Head
 Ideal for thicker substrates, plus all-around cutting applications.
KCJ-XH-30TN (Titanium)
 Titanium coated blade for increased durability



KCJ-XH-40

Locking Tab

KCJ-XH-40 Kurve Head
 Ideal for more abrasive substrates plus all around cutting applications.



KCJ-XH-35

Locking Tab

Metal Tape Splitter and Scraper

KCJ-XH-35 Multipurpose Wide Head
 Ideal for thicker substrates, multipurpose use and all-around cutting applications. Innovative metal scraper and tape splitter make this a versatile, multipurpose tool for any industry.

REMOVING THE HEAD

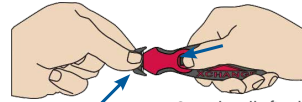

Grasp head guard firmly.

Grasp handle firmly while pressing thumb down on locking tab.

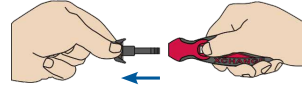

Pull the head from the handle.

INSERTING THE HEAD

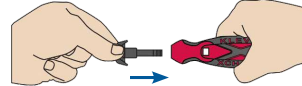

Important: Insert new head until locking tab clicks in place. Head should **NOT** pull back out without depressing the locking tab.

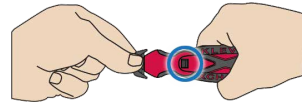

KLEVER HOLSTER



KCJ-HOL

Safety & Convenience

- Safely store cutters and replacement blades.
- Conveniently velcro to your belt.
- Storage pocket for spare/alternate XChange Replacement Heads
- Black

KLEVER XCHANGE PLUS-HD

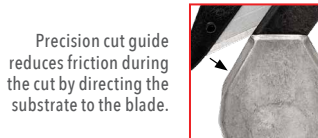
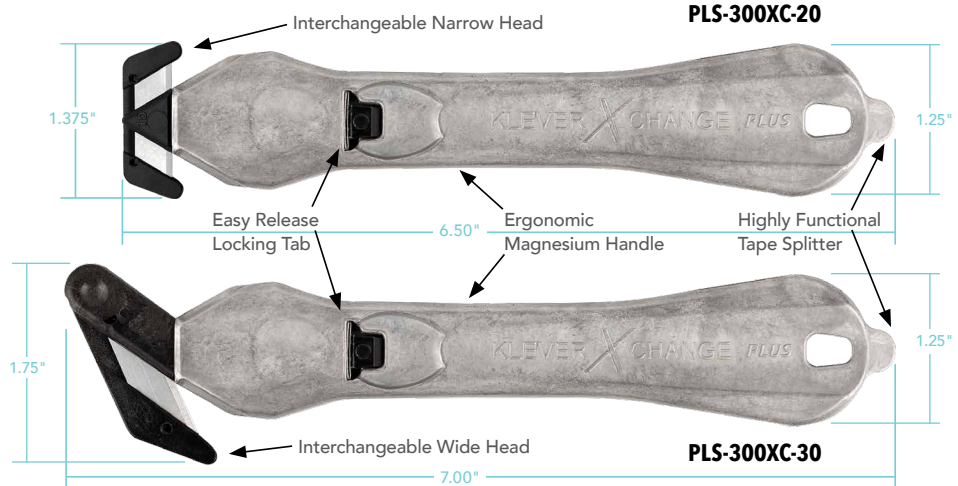
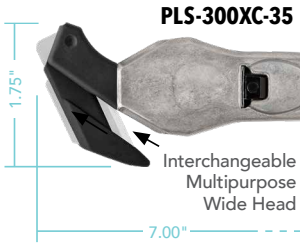
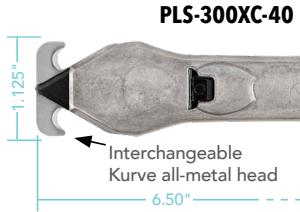

Safety and Convenience

- Recessed blade reduces cut injuries and damaged goods.
 - Cuts boxes, film, tape, and thousands more applications.
 - Magnesium handle for improved durability and increased handle life.
 - Lighter weight ergonomic handle reduces hand and arm fatigue.
 - Highly functional tape splitter
 - Highest safety level
 - Interchangeable, replaceable head.
- (1 pre-loaded head per handle.
Additional sold separately.)



XCHANGE PLUS-OM Magnesium handle with ergonomic 'soft touch.'

KLEVER PLUS SERIES

KLEVER EXCEL *Everything You Love About the XChange — Only Disposable!*

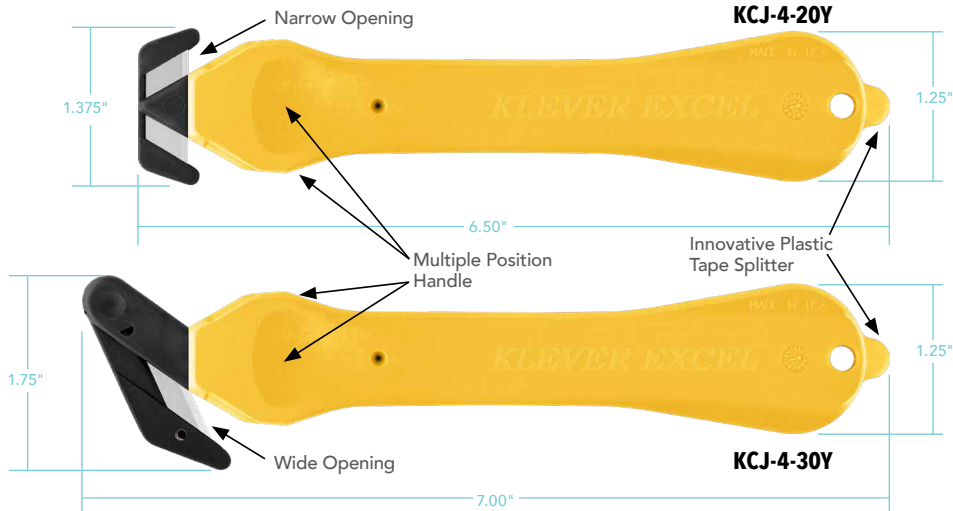

NARROW (20)
Ideal for all around cutting applications.



WIDE (30)
Ideal for thicker substrates, plus all around cutting applications.

Safety and Convenience

- Recessed blade reduces cut injuries and damaged goods.
- Cuts boxes, banding, film, tape, and thousands more applications.
- Multiple position handle; two positions for control and reach
- Available in both narrow and wide heads with durable, high-quality carbon steel blade.
- Innovative plastic tape splitter
- Advanced plastic polymers
- Highest safety level
- Disposable



Handle available in yellow, orange, red, and blue. Complete product listing can be found at the end of the brochure.

KLEVER EXCEL PLUS



Angled blade produces smoother, easier cuts and reduces material bunching.

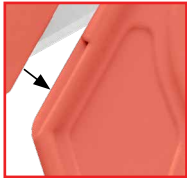

Precision cut guide reduces friction during the cut by directing the substrate to the blade.



Safety and Convenience

- Recessed blade reduces cut injuries and damaged goods.
- Cuts boxes, film, tape, and thousands more applications
- Lighter weight ergonomic handle with less pull force reduces hand and arm fatigue.
- Easier, smoother cutting due to the angle of the recessed, durable, high-quality carbon steel blade.
- Innovative plastic tape splitter
- Advanced plastic polymers
- Highest safety level
- Disposable



Handle available in orange, white, and yellow. Complete product listing can be found at the end of the brochure.

KLEVER KONCEPT *Designed to be A Kut Above*

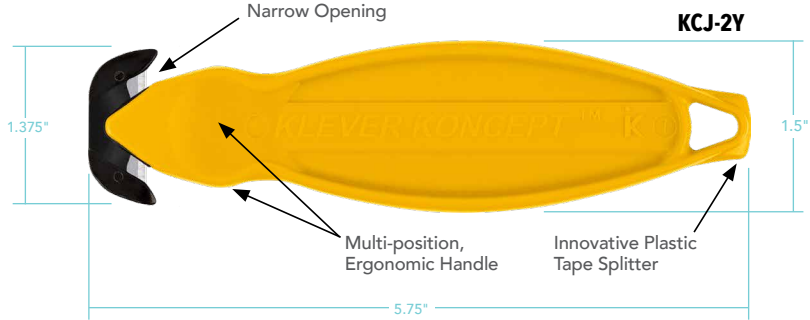

NARROW
Ideal for all around cutting applications.

Safety and Convenience

- Recessed blade reduces cut injuries and damaged goods.
- Cuts boxes, film, tape, and thousands more applications.
- Increased blade exposure with recessed, durable, high-quality carbon steel blade.
- Larger multi-position handle for ergonomic ease of use, with piercing tape splitter.
- Advanced plastic polymers
- Highest safety level
- Disposable



Handle available in yellow, orange, red, and blue. Complete product listing can be found at the end of the brochure.

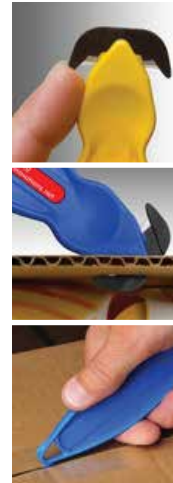

KS-101SS

100% STAINLESS STEEL NSF CERTIFIED SAFETY CUTTER

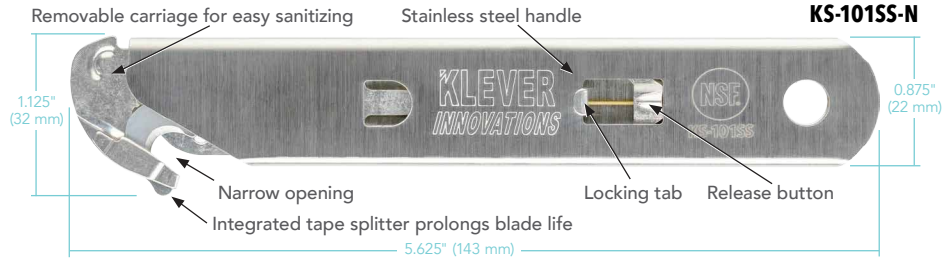

KS-101SS-N
Narrow Opening (0.125" / 3 mm)



KS-101SS-W
Wide Opening (0.25" / 6 mm)



HB-8820SS
Stainless Steel Replacement Blades



NSF Certified for Food Contact

SAFETY AND CONVENIENCE

- Stainless steel handle and carriage
- Stainless steel blade
- Cuts light- to heavy-duty material such as paper/plastic bags, stretch wrap, film, tape, plastic banding, boxes and more.
- Integrated blade-locking system
- Highest safety level
- Tool-free blade changing
- Flip blade for second side use
- Replaceable stainless steel curved blade
(1 pre-loaded head per handle. Additional sold separately.)

KS-101

STAINLESS STEEL SAFETY CUTTER

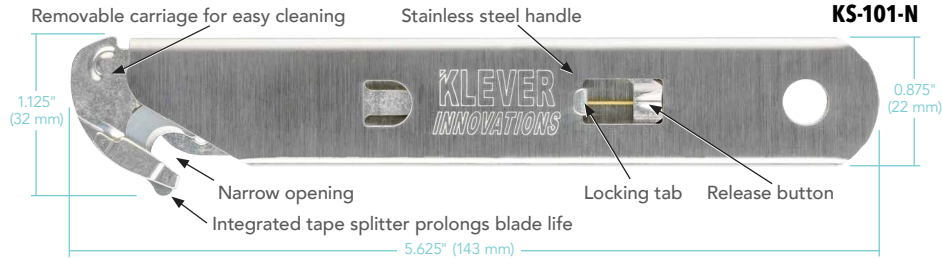

KS-101-N
Narrow Opening (0.125" / 3 mm)



KS-101-W
Wide Opening (0.25" / 6 mm)



HB-8820
Carbon Steel Replacement Blades

SAFETY AND CONVENIENCE

- Stainless steel handle and carriage
- High-quality carbon steel blade
- Cuts light- to heavy-duty material such as paper/plastic bags, stretch wrap, film, tape, plastic banding, boxes and more.
- Integrated blade-locking system
- Highest safety level
- Tool-free blade changing
- Flip blade for second side use
- Replaceable, high-quality carbon steel curved blade (1 pre-loaded head per handle. Additional sold separately.)

KLEEN™ KUTTER

THE KLEVER KUTTER IS NOW ANTIMICROBIAL!

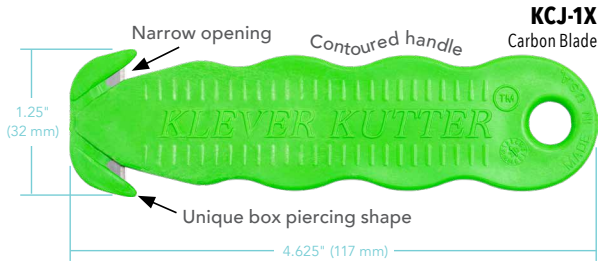

KCJ-1XSS
Stainless Blade



SAFETY AND CONVENIENCE

- Made of an antimicrobial material that is resistant to many bacteria.
- Recessed blade reduces cut injuries and damaged goods.
- Available with high-quality carbon steel blade or stainless steel blade.
- Small, convenient, and durable
- Highest safety level
- Two cutting areas
- Disposable

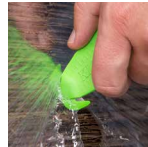
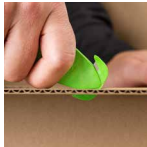

Our recessed-blade technology helps protect employees from cut injuries and merchandise from being damaged – saving you money!

KLEEN™ XCHANGE *THE XCHANGE IS NOW ANTIMICROBIAL*

KEEP THE HANDLE, REPLACE THE HEAD!



SAFETY AND CONVENIENCE

- Made of an antimicrobial material that is resistant to many bacteria.
- Recessed, high-quality carbon steel blade
- Multiple head options to fit any application (*1 pre-loaded head per handle. Additional sold separately.*)
- Ergonomic 'soft touch' handle reduces hand fatigue and stress.
- Innovative metal tape splitter
- Highest safety level

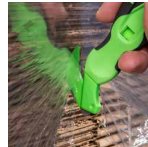
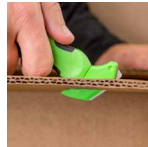

Our recessed-blade technology helps protect employees from cut injuries and merchandise from being damaged – saving you money!

KLEEN™ XCHANGE REPLACEMENT HEADS

XCHANGE REPLACEMENT HEADS ARE NOW ANTIMICROBIAL

Quick-change, snap-in, interchangeable Kleen™ replacement heads compliment the Kleen XChange safety cutter handles. Keep the handle, replace the head! Made of an antimicrobial material that is resistant to many bacteria.



KCJ-XH-20X

Narrow (20) Head

Ideal for all-around cutting applications



KCJ-XH-30X

Wide (30) Head

Ideal for thicker substrates, plus all-around cutting applications



KCJ-XH-35X

Metal Tape Splitter and Scraper

Locking Tab

Multipurpose Wide (35) Head

Ideal for thicker substrates, multipurpose use and all-around cutting applications.

REMOVING THE HEAD

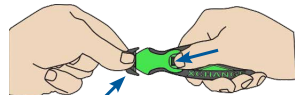

Grasp head guard firmly.

Grasp handle firmly while pressing thumb down on locking tab.

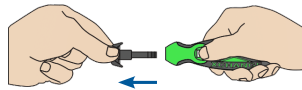

Pull the head from the handle.

INSERTING THE HEAD

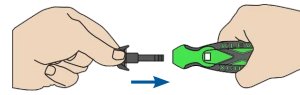

Important: Insert new head until locking tab clicks in place.

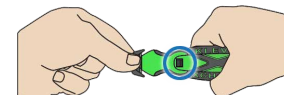

Head should **NOT** pull back out without depressing the locking tab.

KLEVER KUTTER

CERTIFIED FOR NON-SPLASH ZONE

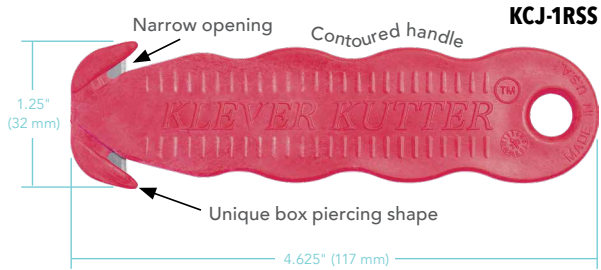

Our recessed-blade technology helps protect employees from cut injuries and merchandise from being damaged – saving you money!

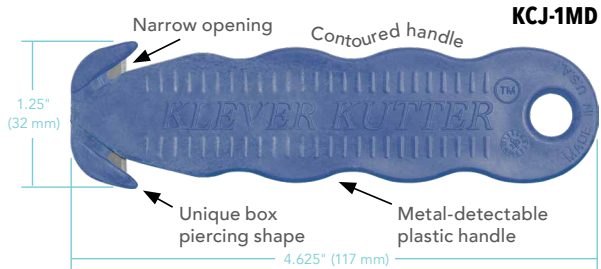

Since all environments differ, we recommend evaluating product detectability with your own test equipment.

SAFETY AND CONVENIENCE

- Recessed stainless steel blade reduces cut injuries and damaged goods.
- Cuts boxes, film, tape, and thousands more applications.
- Small, convenient, and durable
- Advanced plastic polymers
- Highest safety level
- Disposable
- Certified for non-splash zone

KLEVER EXCEL PLUS-MD

METAL DETECTABLE



Angled blade produces smoother, easier cuts and reduces material bunching.

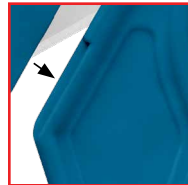

Precision cut guide reduces friction during the cut by directing the substrate to the blade.

SAFETY AND CONVENIENCE

- Recessed, high-quality carbon steel blade reduces cut injuries and damaged goods.
 - Cuts boxes, film, tape, and thousands more applications.
 - Lighter weight ergonomic handle with less pull-force reduces hand/arm fatigue.
 - Easier, smoother cutting due to the angle of the recessed, durable, high-quality carbon steel blade.
 - Innovative plastic tape splitter
 - Metal detectable plastic handle
- Since all environments differ, we recommend evaluating product detectability with your own test equipment.*
- Highest safety level
 - Disposable

Safety Recommendations

- Place non-cutting hand above/away from cut path.
- Do NOT modify our product - use only as intended.
- Dispose of worn product.

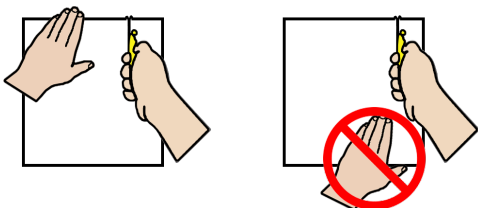

CAUTION: Even though these are Safety products, please understand that blade edges are sharp. **HANDLE WITH CARE.**

Visit www.kleverinnovations.net for videos of proper use and additional safety information.

Boxes

- Align cutter opening at corner/edge of box.
- Angle handle slightly to improve ease of cut.
- Pull cutter with even force to cut box.

Tip: Klever safety cutters have different openings; select based on box material and application.

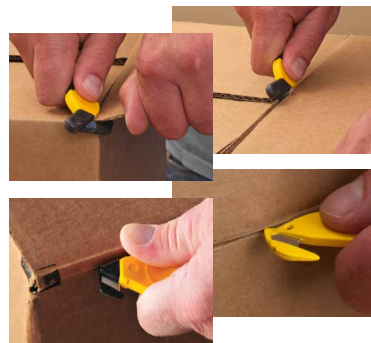

Tape

- Align cutter opening with edge of tape.
- Pull through tape to cut.

Tip: Cutting tape with **tape splitter** end can reduce tape residue on blade, and prolong blade life. Push splitter end down and through tape.



What Are You Cutting?

Our Cutters are designed for multiple industries, multiple uses.

Straps / Banding

- Align cutter opening with edge of strap or band.
- Cut banding at a downward 45° angle.



Tip: Klever safety cutters are not designed to cut metal banding.

Plastic / Film / Wrap

- Align cutter opening with edge of material.
- Pull cutter in a straight line with even force to cut through material.



Tip: Start the cut from the bottom of the material and pull up toward the top of the pallet. Keep material taut while cutting.

Mailing / Box Label

- Align cutter tip with outer edge of label.
- Press tip just beneath top layer of box.
- Angle cutter about 45° to box.
- Pull to cut around label.
- Lift up on corner of cut and peel off.



Tip: Repeating for all sides of label allows for clean removal.

Packing Slip Envelope

- Align cutter tip with top of envelope.
- Apply downward pressure and pull the blade through the stop sheet of plastic.



Tip: Be careful not to press too deep. Avoid contacting contents of envelope.

Visit www.kleverinnovations.net for videos of proper use and additional safety information.

CAUTION: Even though these are Safety products, please understand that blade edges are sharp. **HANDLE WITH CARE.**

Combining Forces for Cutting Safety

Visit our websites for videos of proper use and additional safety information.



www.kleverinnovations.net

www.phcsafety.com



Klever Innovations
Grand Haven, MI
1-800-218-3068

Pacific Handy Cutter
Irvine, CA
1-800-229-2233

Safety Recommendations

- Place non-cutting hand above/away from cut path.
- Do NOT modify our product - use only as intended.
- Dispose of worn product.

Available through



What Are You Cutting?

Our Cutters are designed for multiple industries, multiple uses.



Boxes



Standard Corrugated



Thicker Corrugated



Tape

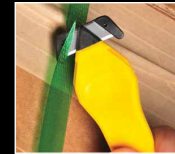

Banding



Film

Cutting Tips

(See pages 20-21 for tips and recommendations)

- Cut banding at a downward 45° angle.
- Start the stretch wrap cut from the bottom and pull up towards the top of the pallet.
- Start cut at corner opening of box.
- Angle handle slightly to improve smoothness of cut.

CAUTION: Even though these are safety products, please understand that blade edges are sharp.
HANDLE WITH CARE.

KLEVER SAFETY CUTTERS

NEWEST ITEMS

KLEEN™ KUTTER



KCJ-1X
KCJ-1XSS Stainless Blade

KLEEN™ XCHANGE



Handle with Narrow (20) Head
KCJ-XC-20X



Handle with Wide (30) Head
KCJ-XC-30X



Handle with Multipurpose Wide (35) Head
KCJ-XC-35X

KLEEN™ XCHANGE REPLACEMENT HEADS

Narrow (20) Head
KCJ-XH-20X

Wide (30) Head
KCJ-XH-30X

Multipurpose Wide (35) Head
KCJ-XH-35X

KS-101SS



Narrow Opening
KS-101SS-N Stainless Blade



Wide Opening
KS-101SS-W Stainless Blade

KS-101



Narrow Opening
KS-101-N Carbon Blade



Wide Opening
KS-101-W Carbon Blade

KLEVER STAINLESS SERIES REPLACEMENT BLADES

HB-8820SS Stainless Steel

HB-8820 Carbon Steel

DISPOSABLE

KLEVER KUTTER



KCJ-1B Blue
KCJ-1Y Yellow
KCJ-1R Red
KCJ-1G Orange
KCJ-1K Black
KCJ-1MD Metal Detectable,
Stainless Steel Blade
KCJ-1RSS Stainless Steel Blade

KLEVER KUTTER PLUS



PLS-100Y Yellow
PLS-100G Orange
PLS-100W White

KLEVER KONCEPT



KCJ-2B Blue
KCJ-2Y Yellow
KCJ-2R Red
KCJ-2G Orange

KLEVER EXCEL



Narrow (20) Head:
KCJ-4-20B Blue
KCJ-4-20Y Yellow
KCJ-4-20R Red
KCJ-4-20G Orange



Wide (30) Head:
KCJ-4-30B Blue
KCJ-4-30Y Yellow
KCJ-4-30R Red
KCJ-4-30G Orange

KLEVER EXCEL PLUS



PLS-400-30Y Yellow
PLS-400-30G Orange
PLS-400-30W White
PLS-400-30MD
Metal Detectable

KEEP THE HANDLE, REPLACE THE HEAD!

KLEVER XCHANGE



Handle with Narrow (20) Head
KCJ-XC-20B Blue
KCJ-XC-20Y Yellow
KCJ-XC-20R Red
KCJ-XC-20G Orange
KCJ-XC-20Y-PT Yellow Plastic Tape Splitter



Handle with Wide (30) Head
KCJ-XC-30B Blue
KCJ-XC-30Y Yellow
KCJ-XC-30R Red
KCJ-XC-30G Orange
KCJ-XC-30Y-PT Yellow Plastic Tape Splitter



Handle with Multipurpose Wide (35) Head
KCJ-XC-35B Blue
KCJ-XC-35Y Yellow
KCJ-XC-35R Red
KCJ-XC-35G Orange
KCJ-XC-35Y-PT Yellow Plastic Tape Splitter



Handle with Kurve (40) Head
KCJ-XC-40B Blue
KCJ-XC-40Y Yellow
KCJ-XC-40R Red
KCJ-XC-40G Orange
KCJ-XC-40Y-PT Yellow Plastic Tape Splitter

KLEVER XCHANGE REPLACEMENT HEADS

Narrow (20) Head
KCJ-XH-20,
KCJ-XH-20TN (Titanium Coated)

Wide (30) Head
KCJ-XH-30,
KCJ-XH-30TN (Titanium Coated)

Multipurpose Wide (35) Head
KCJ-XH-35

Kurve (40) Head
KCJ-XH-40

KLEVER HOLSTER

KCJ-HOL Black



KLEVER XCHANGE PLUS



Handle with Narrow (20) Head
PLS-200XC-20Y Yellow
PLS-200XC-20G Orange
PLS-200XC-20W White



Handle with Wide (30) Head
PLS-200XC-30Y Yellow
PLS-200XC-30G Orange
PLS-200XC-30W White



Handle with Multipurpose Wide (35) Head
PLS-200XC-35Y Yellow
PLS-200XC-35G Orange
PLS-200XC-35W White

KLEVER XCHANGE PLUS-HD



Handle with Narrow (20) Head
PLS-300XC-20



Handle with Wide (30) Head
PLS-300XC-30



Handle with Multipurpose Wide (35) Head
PLS-300XC-35



Handle with Kurve (40) Head
PLS-300XC-40

KLEVER XCHANGE PLUS-OM



Handle with Narrow (20) Head
PLS-302XC-20



Handle with Wide (30) Head
PLS-302XC-30



Handle with Multipurpose Wide (35) Head
PLS-302XC-35



Handle with Kurve (40) Head
PLS-302XC-40

